

PARKDALE COMMUNITY RINK REPLACEMENT PROJECT UPDATE

PARKDALE COMMUNITY ASSOCIATION

FEBRUARY 6, 2019

PROJECT OVERVIEW & COMMUNITY BENEFITS

- **Parkdale Outdoor Rink has reached end of usable life**
 - Vehicle access to rink restricted due significant damage to gates
 - Boards require replacement again (replaced multiple times, require another replacement)
 - Significant lighting & electrical repairs required
- **Benefits to Community**
 - Supports outdoor hockey programs (Grassroots hockey, sledge hockey, rentals with amateur teams, etc)
 - Amazing outdoor space to bring community members together
 - Rentable event space for community members in summer & winter
 - Unrestricted access, unlike many new community outdoor rinks
 - Inner city outdoor rink supports multiple surrounding communities
 - Attracts youth clubs & amateur sport clubs to the community

REPLACEMENT SCOPE

- Essentially a direct replacement
- Focused on safety, lighting, security, access (large and small gates)
- Design modeled after of Lakeview Community Outdoor Rink

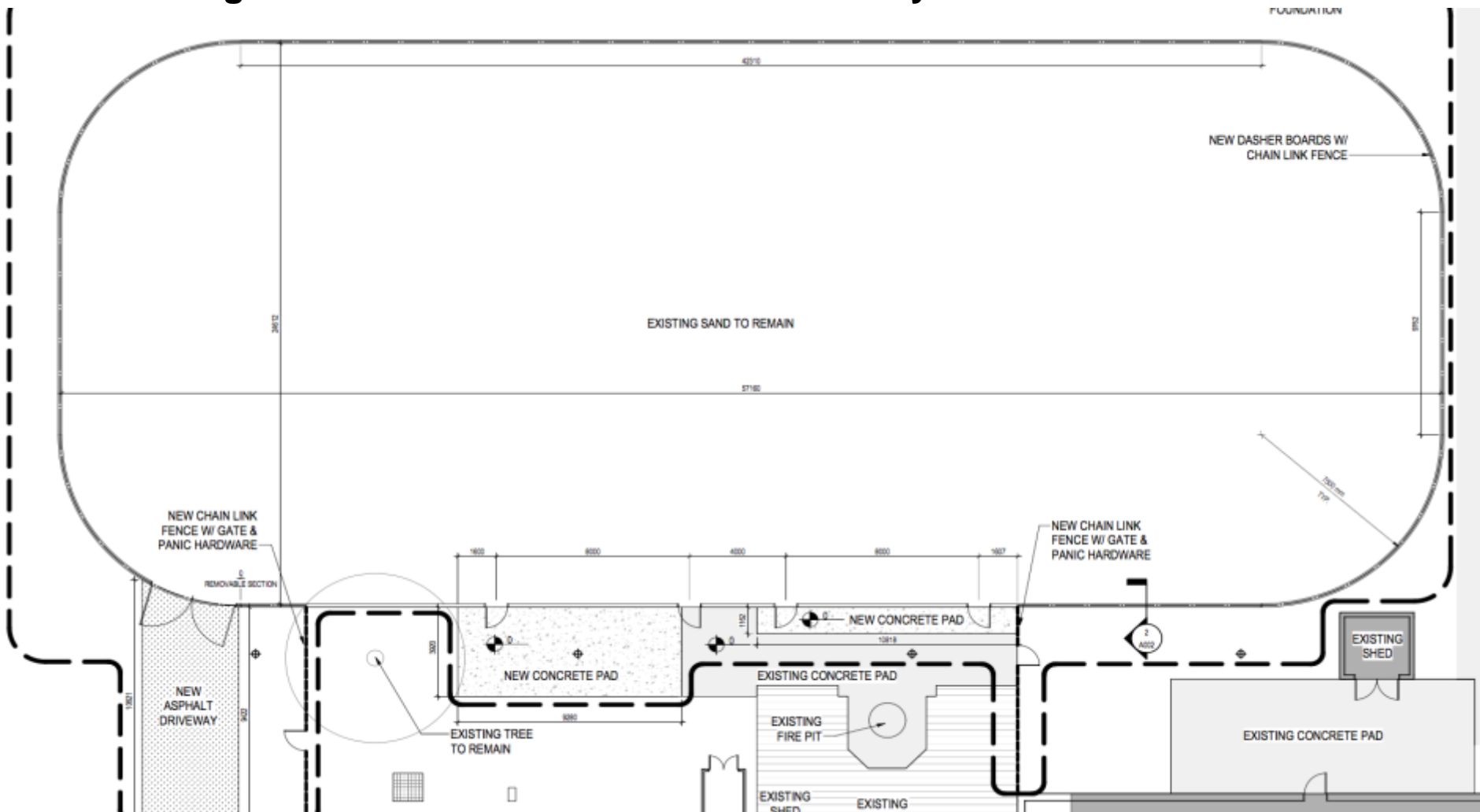

REPLACEMENT BUDGET

- High level estimate from Stantec
- Once design finalized, Stantec will administer RFP and obtain quotes
- Can be completed in stages based on approved funding plans
- Construction season to be on either side of summer volleyball

| Description | QTY | Unit | Total | Total (incl.10% contingency) |
|---|-----|------|---------------------|------------------------------|
| Demolition | - | L.S | 30,000.00 | 33,000.00 |
| Foundation/Footing | - | L.S | 60,000.00 | 66,000.00 |
| Dasher Boards | - | L.S | 110,000.00 | 121,000.00 |
| Chain Link Fencing (on top of dasher boards & west to bldg) | - | L.S | 40,000.00 | 44,000.00 |
| Seat Boxes | - | L.S | 15,000.00 | 16,500.00 |
| Concrete Pad on West side of Rink | - | L.S | 13,200.00 | 14,520.00 |
| Asphalt lane | - | L.S | 1,500.00 | 1,650.00 |
| Remove & Replace existing rink lighting (8 fixtures), incl. new bases | - | L.S | 95,000.00 | 104,500.00 |
| Landscape re-hab around rink & concrete pad | - | L.S | 8,000.00 | 8,800.00 |
| Total Outdoor Rink Replacement | | | \$372,700.00 | \$409,970.00 |

SOCIAL AREA SCOPE

- Summer & Winter change areas
- Access inclusive for people of all abilities (including sledge hockey access)
- Fireplace repair
- Expanded Patio
- New storage space

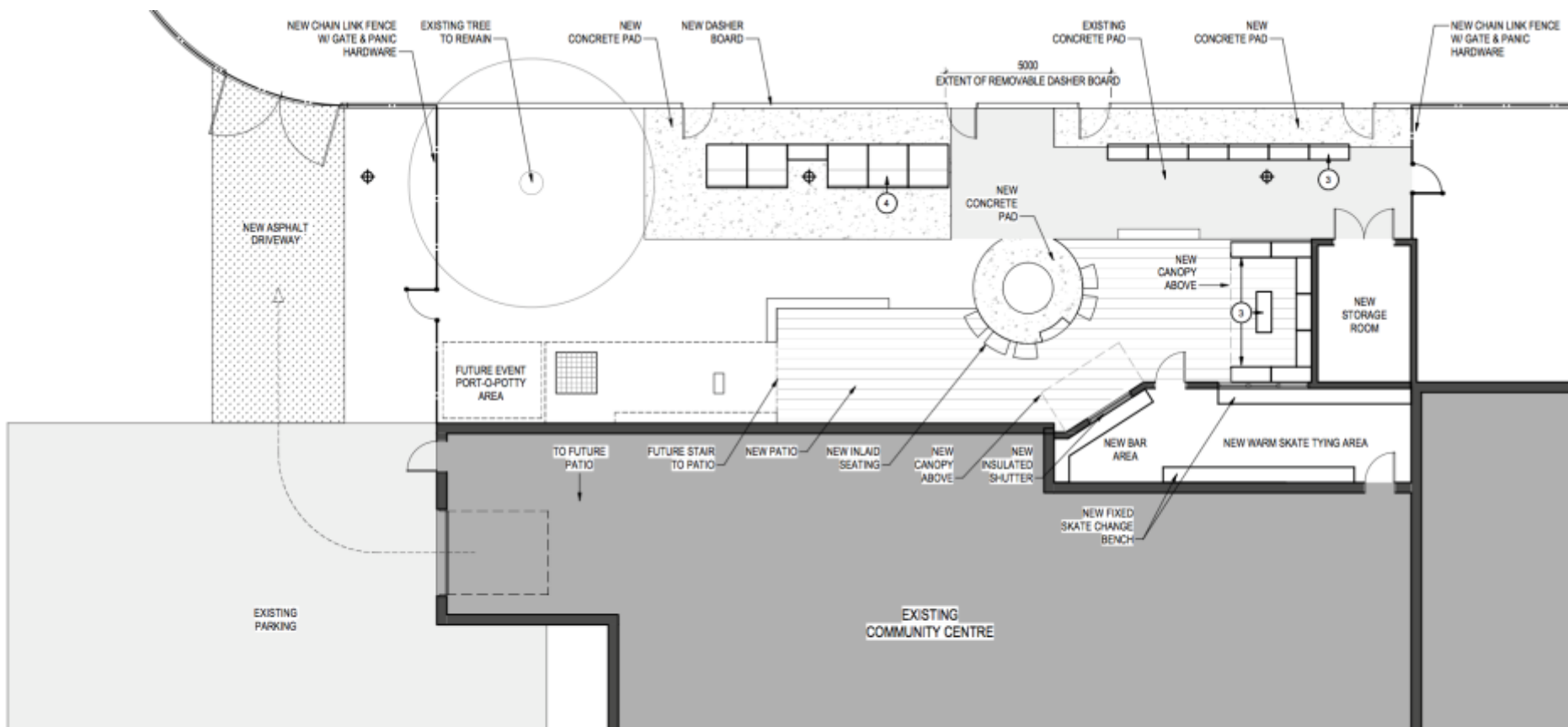

SOCIAL AREA BUDGET

- **\$75,000 - \$100,000**
- **Initial estimates extremely high level**
- **Waiting to finalize design with Stantec**
- **Open to partners on the project. Potential benefits to partners include:**
 - Customizing design
 - Advertising
 - Naming



\$500,000 FUNDING PLAN

- **\$125,000 CFEP (community facility enhancement program) grant**
- **Approved**
- **\$300,000 CCG (City of Calgary Capital Conservation reimbursement Grant) – Conditionally Approved**
- **165,000 GoFundMe Campaign – In Progress**
https://www.gofundme.com/parkdale-community-rink-65-year-anniversary?sharetype=teams&member=1576830&rcid=r01-154932974972-e425cc48c45c4ad5&pc=ot_co_campmgmt_w
 - Required to enable construction to begin
- **Other significant grant options being investigated**
 - Co-op community spaces
 - Calgary Parks Foundation
- **Parks Foundation Project Gift Administration services:**
 - Receiving donations & issuing tax receipts
 - Fundraising and additional grant support
 - Processing payments for approved invoices for the project
 - Providing financial reports for the project
 - Eligibility for parks foundation granting programs

HOW CAN YOU HELP?

- **Donate to the campaign**
- **Spread the word**
- **Help us find and secure sources of funding**
- **Volunteer and get involved with our committee**
- **?**