



PARKDALE land use + development study

In the fall of 2014 the Parkdale Community Association (PCA) identified the need for a comprehensive plan that could address the existing and forthcoming issues associated to land use and development in the neighbourhood. In collaboration with the Federation of Calgary Communities (FCC), and as part of the Urban Alliance, a partnership between the City of Calgary and the University of Calgary, the Faculty of Environmental Design (EVDS) was approached to work together with the PCA to develop a study that could become the foundation for a future land use and development plan.

The Parkdale Land Use and Development Study, was selected as one of the final project for the course EVDP 644 - Advanced Professional Planning Project in the Master of Planning. Students will focus on current urban development issues and produced a final report that addresses the most pressing issues and provides potential strategies for future development.

Our Approach

Our approach included background research, inventory and analysis, and an iterative concept development process. The students will undertake an in depth analysis of the community and its surrounding area, and in consultation with community members will derived issues, opportunities and constraints that will set the stage for the development of concepts and strategies. The final deliverable will be a graphic report with the proposed concepts from each student team (4 in total) and a summary of their research.

Some of the issues already identified include but are not limited to:

- Creating a Parkdale identity that recognizes its heritage as well as its unique location
- Enhancing mobility and safe linkages within community
- Guidelines for the appropriate implementation of City of Calgary Corridor Study along Parkdale Blvd - 29 St. NW and Parkdale Blvd./3rd Ave./Bowness Rd. NW
- Redevelopment of the Provincial lands and the "BECCA" site west of 37 St. NW
- Assess options for enhancing the community open space adjacent to the Parkdale community centre
- Assess impact and implementation guidelines to increase density, such as through the creation of laneway housing, basement suites, etc.

The proposed strategies and concepts will be based on findings from the analysis and will be supported by extensive technical and precedent research.

Public consultation is a fundamental part of the planning process. It is the intent of this studio to incorporate community consultation as a key part of the project. Two opportunities for input will included: a Issues, Opportunities and Constraints Workshop where students will work with community members in reviewing their analysis and developing conclusions, and a Final Concepts Open House where the public will review and commented on the proposed designs and strategies.



The time line for the project was compact and limited to the academic winter term. The project extended from the beginning of January to the end April of 2015. Below is a process diagram with the different groups involved, review dates and public participation opportunities.

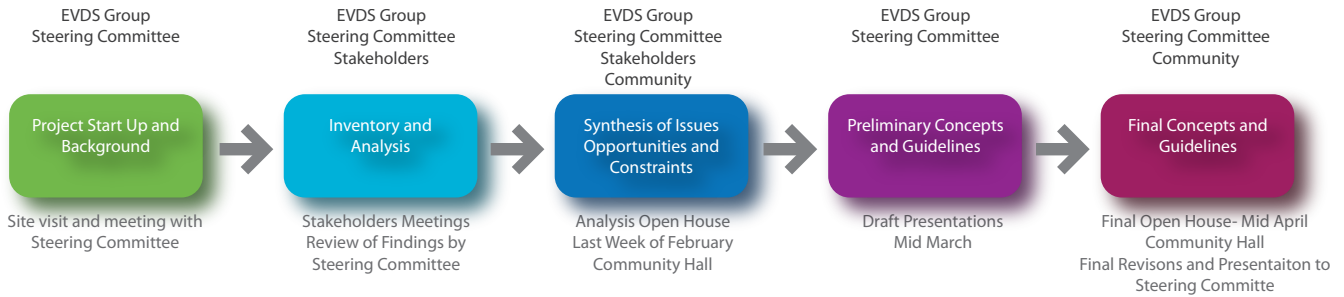

Project Site

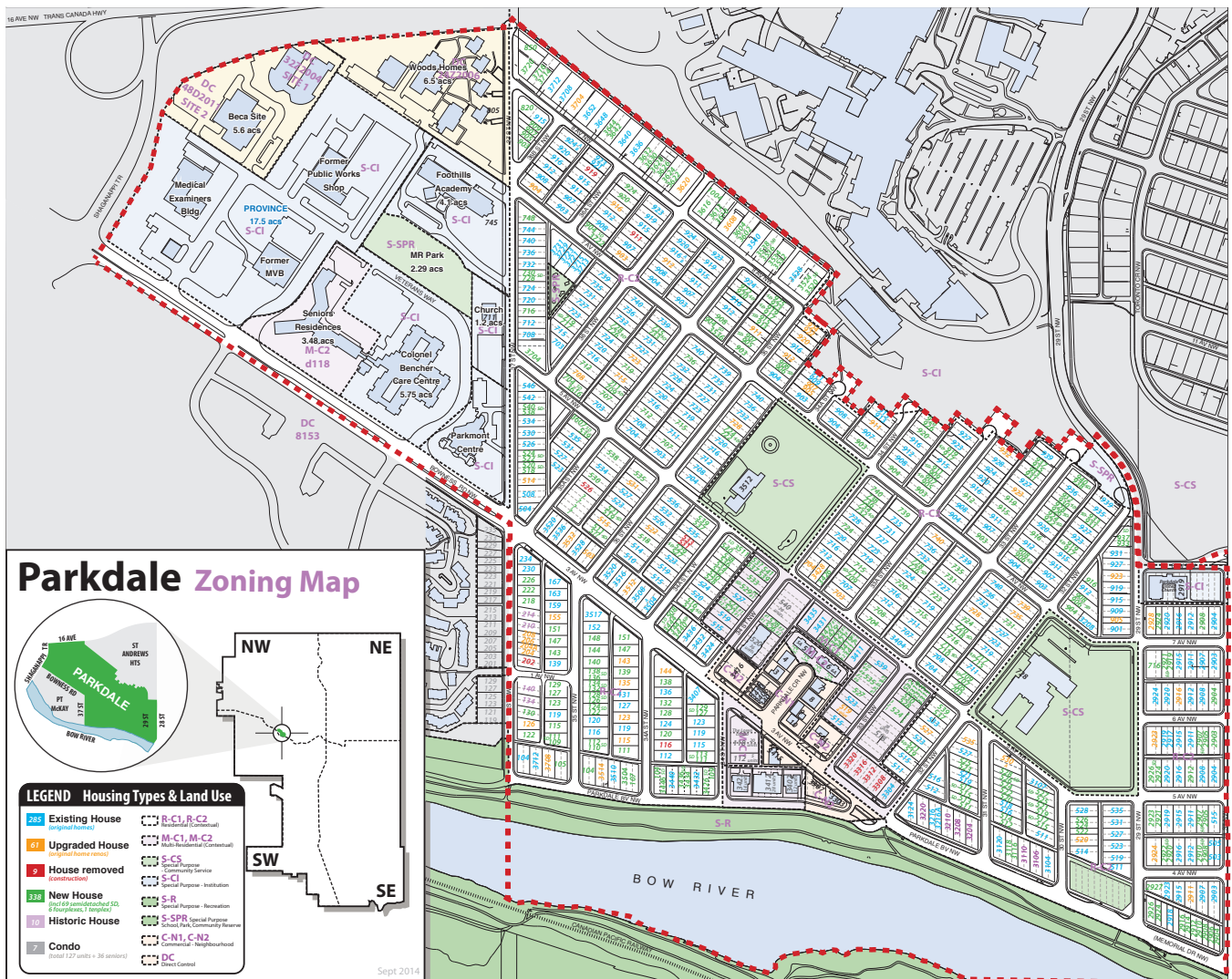



Schedule - Draft, to be confirmed

EVDS616_schedule_winter2015			
			revised 9.dec.2014
WEEK	DATE	LOCATION	CLASS
1	Mon, Jan 12, 2015	PF3160	Lecture; Class and project introduction and workplan development
	Wed, Jan 14, 2015	Studio	Data gathering/base map development/Group meetings
	Fri, Jan 16, 2015	On Site	Site Visit and meeting with Community Assoc. Leadership
2	Mon, Jan 19, 2015	Studio	Desk crits
	Wed, Jan 21, 2015	Studio	WORKPLAN DUE (10%)
	Fri, Jan 23, 2015	Studio	Inventory and Analysis
3	Mon, Jan 26, 2015	TBD	Meeting with Developers
	Wed, Jan 28, 2015	Studio	Inventory and Analysis
	Fri, Jan 30, 2015	Studio	Inventory and Analysis
4	Mon, Feb 2, 2015	TBD	Meeting with City of Calgary Planning / Neighbourhood Services
	Wed, Feb 4, 2015	Studio	Inventory and Analysis
	Fri, Feb 6, 2015	Studio	Inventory and Analysis
5	Mon, Feb 9, 2015	Studio	Inventory and Analysis
	Wed, Feb 11, 2015	Studio	Inventory and Analysis
	Fri, Feb 13, 2015	TBD	ANALYSIS DUE - Presentation (25%)
6	Mon, Feb 16, 2015	No Class	BLOCK WEEK
	Wed, Feb 18, 2015	No Class	BLOCK WEEK
	Fri, Feb 20, 2015	No Class	BLOCK WEEK
7	Mon, Feb 23, 2015	Studio	Preparation for open house
	Wed, Feb 25, 2015	Studio	Preparation for open house
	Fri, Feb 27, 2015	TBD	ANALYSIS OPEN HOUSE / WORKSHOP
8	Mon, Mar 2, 2015	Studio	Development of draft design
	Wed, Mar 4, 2015	Studio	Development of draft design
	Fri, Mar 6, 2015	Studio	Development of draft design
9	Mon, Mar 9, 2015	Studio	Development of draft design
	Wed, Mar 11, 2015	Studio	Development of draft design
	Fri, Mar 13, 2015	Studio	Development of draft design
10	Mon, Mar 16, 2015	Studio	Development of draft design
	Wed, Mar 18, 2015	Studio	Development of draft design
	Fri, Mar 20, 2015	TBD	DRAFT DUE - Presentation (25%)
11	Mon, Mar 23, 2015	Studio	Review and development of final design
	Wed, Mar 25, 2015	Studio	Review and development of final design
	Fri, Mar 27, 2015	Studio	Review and development of final design
12	Mon, Mar 30, 2015	Studio	Review and development of final design
	Wed, Apr 1, 2015	Studio	Review and development of final design
	Fri, Apr 3, 2015	Studio	Review and development of final design
13	Mon, Apr 6, 2015	Studio	Review and development of final design
	Wed, Apr 8, 2015	Studio	Review and development of final design
	Fri, Apr 10, 2015	Studio	Review and development of final design
14	Mon, Apr 13, 2015	Studio	Review and development of final design
	Wed, Apr 15, 2015	Studio	Last Day of Classes
	Fri, Apr 17, 2015	TBD	FINAL PRESETATIONS (20%)
15	Mon, Apr 20, 2015	Studio	No Class/ Meeting with instructor if requested
	Wed, Apr 22, 2015	Studio	No Class/ Meeting with instructor if requested
	Fri, Apr 24, 2015	TBD	FINAL OPEN HOUSE (Document Due) (20%)